



# AUCTION

**TOOLING TECHNOLOGIES MANUFACTURING, LLC**  
11680 BRITTMORE PARK DRIVE, HOUSTON, TEXAS 77041

**THURSDAY, JULY 10 • 10:00 A.M. CDT**  
**LIVE WEBCAST – NO ONSITE BIDDING**

**REGISTER NOW BidSpotter OR proxibid**

**VIEW LOT CATALOG & REGISTER NOW!**



OKUMA IMPACT LU15 CNC LATHE



SWISS STAR ECAS-20 CNC SCREW MACHINE



VICTOR JF-2VS VERTICAL TURRET MILL



TRAK DPM5 CNC BED MILL



CHAMPION AIR COMPRESSOR



VICTOR 1760T ENGINE LATHE



KNIGHT GLOBAL FLOOR MOUNTED RAIL SYSTEM



20' CONEX BOX

**PLANT CLOSING:**  
CNC LATHES &  
SCREW MACHINE;  
VERT. TURRET MILL;  
ENGINE LATHE;  
PRESSES;  
HIGH PRESSURE  
COOLANT SYSTEM;  
GANTRY CRANE  
SYSTEM; SHOP  
SUPPORT; OFFICES;  
INVENTORY; MORE!



SAMPLE VIEW OF TOOLING



ENERPAC DIRECTIONAL CONTROL VALVES

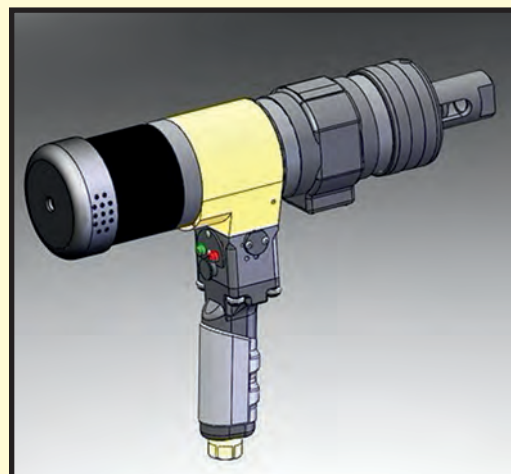

MOAD 200 SELF COLLECTING AIRCRAFT DRILLS



ATLAS COPCO SMART TORQUE WRENCH

**DATE: THURSDAY, JULY 10 • 10:00 A.M. CDT**  
**LIVE WEBCAST – NO ONSITE BIDDING**  
**LOCATION: HOUSTON, TEXAS**

**INSPECTION: TUESDAY & WEDNESDAY, JULY 8 & 9, 9:00 A.M. TO 4:00 P.M. EACH DAY**

**BUYER'S PREMIUM: 18%**

**ADD AUCTION TO CALENDAR:**



**CONTACT PMI FOR MORE INFORMATION**  
**pmi@pmi-auction.com • (713) 691-4401**

Sale Conducted By:

**PLANT & MACHINERY INC.**  
AUCTIONEERS • APPRAISERS • LIQUIDATORS • REAL ESTATE

Ron Moore, TX Lic. #7314

E-MAIL: [pmi@pmi-auction.com](mailto:pmi@pmi-auction.com)

WEBSITE: [www.pmi-auction.com](http://www.pmi-auction.com)

Headquarters:

1304 Langham Creek Drive, Suite 454

Houston, Texas 77084

PHONE: (713) 691-4401

FAX: (713) 672-7905